

Specifications — ACMP 100

General

Mounting..... Flat surface mountable

NOTE *The ACMP 100 can be angled -5° to +95° to level an angled ceiling, and it accepts a 1.5" diameter (o.d.), 11.5 NPT/NPS extension column.*

Maximum load capacity..... 200 lbs.

Material..... Steel

Dimensions 4.3" H x 3.4" W x 7.5" D
11.0 cm H x 8.6 cm W x 19.1 cm D

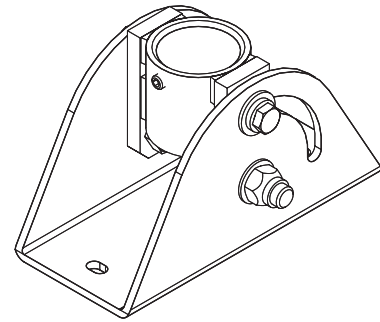
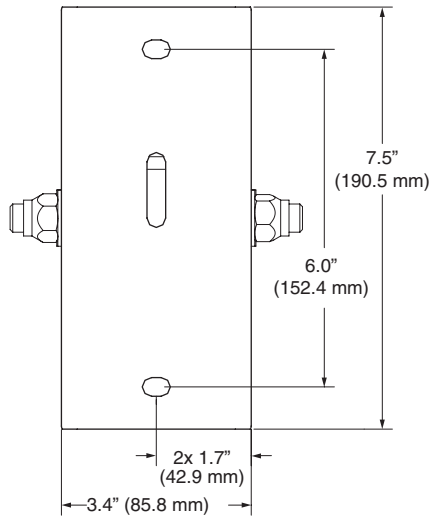
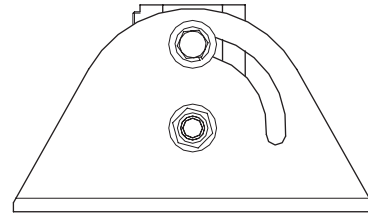
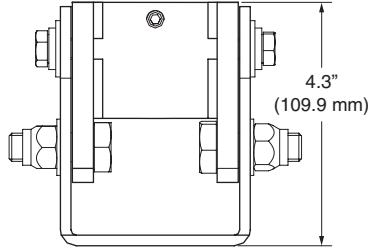

Product weight 4.9 lbs (2.2 kg)

Shipping weight 6 lbs (3 kg)

Vibration ISTA 1A in carton (International Safe Transit Association)

Listings..... UL, CUL

Compliances..... CE, OSHPD anchorage pre-approval

Warranty 3 years parts and labor

NOTE *Specifications are subject to change without notice.*

(7.53-101907-D1)